

A prescription (plan) for a healthier you has arrived

Turn over to learn more and register >>

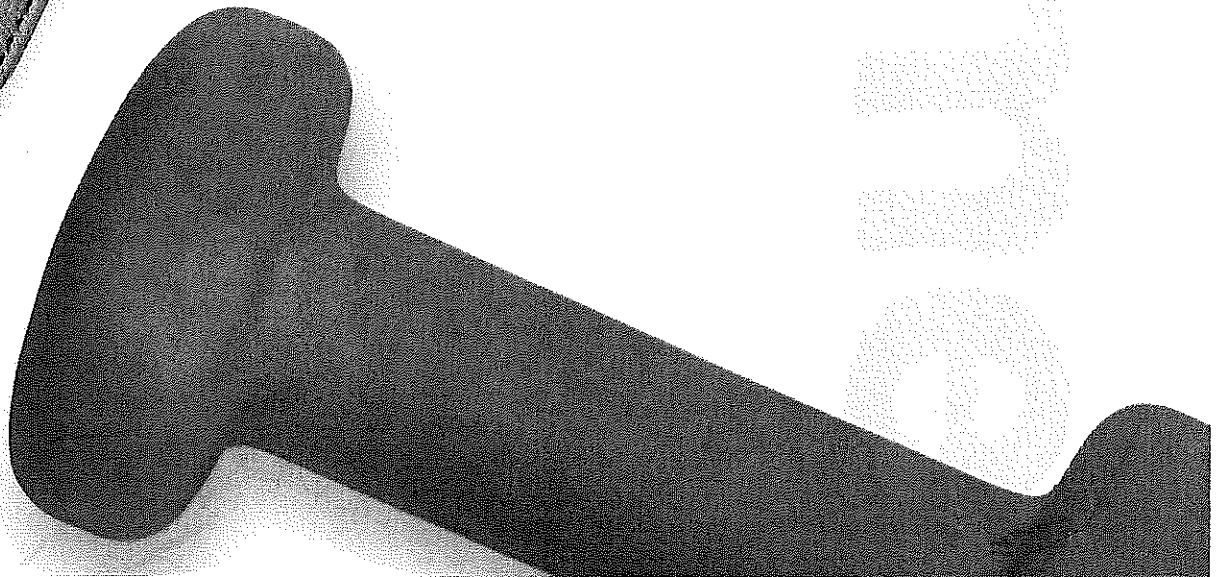

Welcome to CVS Caremark®

We're glad to meet you

Know you can count on us for a wide range of cost-effective medications, thousands of network pharmacy choices (including home delivery) and select participating pharmacies for specialty medications. All this is built into your plan.

First, let's get connected

Register for an online account so you don't miss out on any of your plan benefits or updates. Scan the QR code on the right or go to **Caremark.com/StartNow** to get set up today.

You're off to a great start

After you register, be sure to visit our website so you can learn about your new plan and how it works.

- Check out your plan and deductible details
- Print an ID card to use at the pharmacy
- See if your medication is covered and how much it costs
- Locate a network pharmacy near you
- Find out if there are any ways to save on your medication
- Tell us how to contact you (by text, email or other)

You've got this

But if you need help along the way, you can always find answers on our website or call us at the number on your ID card.

Register today at **Caremark.com/StartNow**

Members acknowledge that by directing their prescribers, or their agents, to send prescriptions to CVS Caremark they are also providing express consent for CVS Caremark to provide prescription services to those members for those prescriptions. Members acknowledge that by directing their prescribers, or their agents, to send prescriptions to the applicable specialty pharmacy, they may also provide express consent to utilize any affiliated pharmacies to process their prescriptions. Plan Member Rights and Responsibilities can be found at Caremark.com.

©2023 CVS Caremark. All rights reserved. 106-52786D 103023

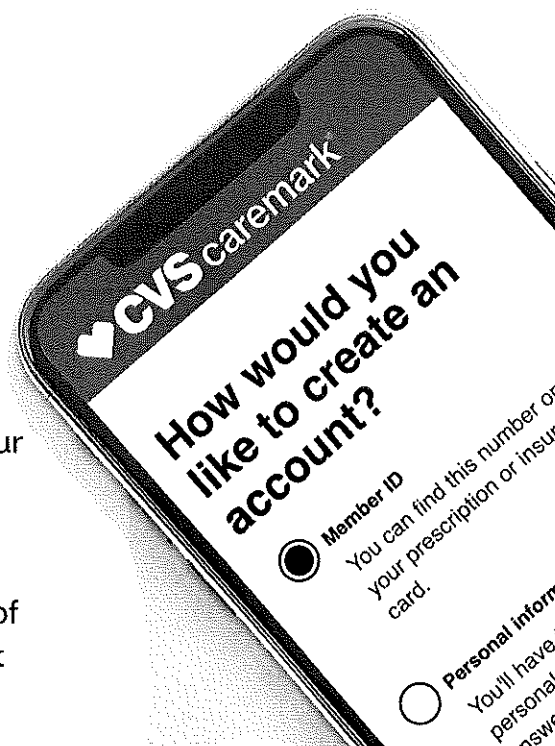

Scan the code to register

- Open the camera on your smart phone
- Focus on the QR code
- Tap the link that appears





Important Information About Your Prescription Plan

Your New ID Cards Are on the Way!

Effective April 1st, 2025, CVS/Caremark will assume responsibility for processing prescription claims. This will not affect your prescription plan coverage; however, this step will require us to issue, and members to use, a new prescription plan ID card.

As an added convenience, your medical plan and prescription plan ID cards **have been combined**; *new Meritain ID cards have been issued, which includes CVS/Caremark prescription plan information.*

Please note that it is necessary the updated prescription plan information is given to your pharmacist when filling prescriptions on or after April 1st, 2025.

**Please be on the lookout for a NEW ID CARD in the mail—
it is important you inform your pharmacist of this change for any prescriptions
needed on or after April 1, 2025.**

Your new ID card will look like the example below.

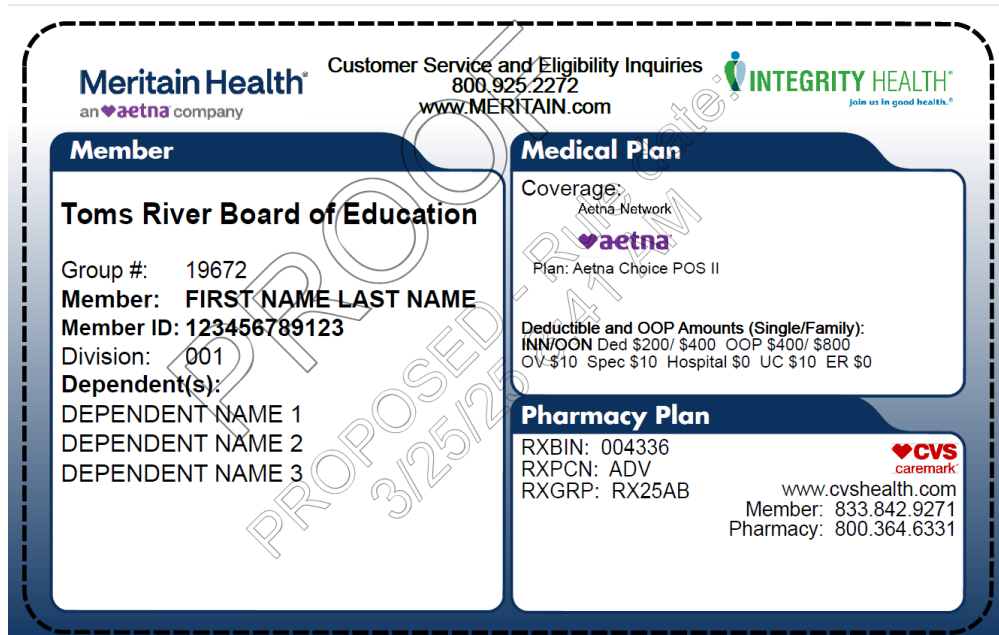

Online access to the CVS/Caremark member website and mobile app, where you can manage your prescription benefits, access digital ID cards, and learn about your medication is also available. To set up your secure log-in for the first time please visit www.Caremark.com.

IMPORTANT NOTES:

- Your updated CVS/Caremark plan information must be provided to your pharmacist when filling scripts on or after April 1st.
- **90-day transition of care:** Although no significant changes in formulary are expected, to maintain uninterrupted access to prescriptions, members can fill a temporary supply of their current medications for *up to 90 days (after the 4/1 effective date)*.
- Your ***prescription plan benefit design remains unchanged*** however, each PBM utilizes a slightly different drug formulary. Pharmacy benefit managers (PBMs) regularly update their formularies to include new drugs and remove others.
- If you have not yet received your updated prescription ID card, a digital ID card is available once you register for your CVS Caremark account at www.Caremark.com.



Learn more at Caremark.com/OpenEnrollment or scan the code.

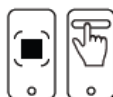

To scan the QR code:
Open the camera on your smart phone
Focus on the QR code
Tap the link that appears

Your Partnership Health Center is here to help make this transition seamless for you.

If you have any questions about this transition, please do not hesitate to contact your Member Advocate and Team Lead, Michelle Grossguth at:

Phone: 732-505-0213, ext. 120

Email: Michelle@integrityhealth.com



Plan Summary

This chart explains what your plan covers and what your share of prescription costs will be. You can also find it on our website.

GARDEN STATE HEALTH PLAN / NEW JERSEY EDUCATOR HEALTH PLAN

Under your plan, prescriptions for long-term medications (used to treat conditions like diabetes, asthma, or high blood pressure) must be filled in 90-day supplies by mail or at an in-network pharmacy. **If you fill these prescriptions in 34-day supplies, your medications won't be covered, and you'll have to pay the entire cost.** Prescriptions for short-term medications (like antibiotics) can be filled at any retail pharmacy in your plan's network.

	Short-Term Medications	Long-Term Medications
	Fill at any pharmacy in your plan's network; Cost for up to a 34-day supply	Fill at any pharmacy in your plan's network; Cost for up to a 90-day supply
Generic Medications Best option to help you save money	\$5 for one 34-day supply	\$15 for one 90-day supply
Preferred Brand-Name Medications Best option when a generic isn't available	\$10 for one 34-day supply	\$30 for one 90-day supply
Refill Limit	75% of supply must be used to obtain refill	75% of supply must be used to obtain refill
Specialty Medications	Generic - \$5 copay, Preferred - \$10 copay	
Maximum Out-of-Pocket	\$1,600 per individual / \$3,200 per family	

Please Note: When a generic is available, but the pharmacy dispenses the brand-name medication for any reason, you will pay the difference between the brand-name medication and the generic plus the brand copayment.

25AB-WKL2-NEW_2023_RETAIL90_MOOP-0325

Register today at [Caremark.com/StartNow](https://www.caremark.com/StartNow)

Oklahoma: Some Oklahoma residents may not be eligible to participate in the Maintenance Choice and/or Exclusive Specialty program. If you have questions about your eligibility, please contact Customer Care at the number on your member ID card.

Specialty pharmacy delivery options are available where allowed by law. In-store pickup is currently not available in Oklahoma. Puerto Rico requires first-fill prescriptions to be transmitted directly to the dispensing specialty pharmacy. Products are dispensed by the applicable specialty pharmacy and certain services are only accessed by calling the pharmacy directly. Certain specialty medications may not qualify.

Products that qualify as preventive services may be available at a lower cost share or no cost share, depending upon your plan, and may change from time to time. Please check your plan benefit materials should you have any questions about your coverage. Certain drug options identified above may be subject to additional prior authorizations or other plan design restrictions. Please consult your plan for further information.

This information is not a substitute for medical advice or treatment. CVS Caremark assumes no liability whatsoever for the information provided or for any diagnosis or treatment made as a result of this information.

Members acknowledge that by directing their prescribers, or their agents, to send prescriptions to CVS Caremark they are also providing express consent for CVS Caremark to provide prescription services to those members for those prescriptions. Members acknowledge that by directing their prescribers, or their agents, to send prescriptions to the applicable specialty pharmacy, they may also be providing express consent to utilize any affiliated pharmacies to process their prescriptions. Plan Member Rights and Responsibilities can be found at [Caremark.com](https://www.caremark.com).





Plan Summary

This chart explains what your plan covers and what your share of prescription costs will be. You can also find it on our website.

PPO PLAN A/ PLAN B

Under your plan, prescriptions for long-term medications (used to treat conditions like diabetes, asthma, or high blood pressure) must be filled in 90-day supplies by mail or at an in-network pharmacy. **If you fill these prescriptions in 30-day supplies, your medications won't be covered, and you'll have to pay the entire cost.** Prescriptions for short-term medications (like antibiotics) can be filled at any retail pharmacy in your plan's network.

	Short-Term Medications	Long-Term Medications
	Fill at any pharmacy in your plan's network; Cost for up to a 30-day supply	Fill at any pharmacy in your plan's network; Cost for up to a 90-day supply
Generic Medications Best option to help you save money	\$3 for one 30-day supply	\$9 for one 90-day supply
Preferred Brand-Name Medications Best option when a generic isn't available	\$10 for one 30-day supply	\$30 for one 90-day supply
Refill Limit	75% of supply must be used to obtain refill	75% of supply must be used to obtain refill
Specialty Medications	Generic - \$3 copay for 34/90-day supply Preferred - \$10 copay for 34-day supply, 20% Coinsurance for 90-day supply	
Maximum Out-of-Pocket	\$6,450 per individual / \$12,700 per family	

25AB-WKL2-NEW_2023_RETAIL90_SM_MOOP-0325

Register today at [Caremark.com/StartNow](https://www.caremark.com/StartNow)

Oklahoma: Some Oklahoma residents may not be eligible to participate in the Maintenance Choice and/or Exclusive Specialty program. If you have questions about your eligibility, please contact Customer Care at the number on your member ID card.

Specialty pharmacy delivery options are available where allowed by law. In-store pickup is currently not available in Oklahoma. Puerto Rico requires first-fill prescriptions to be transmitted directly to the dispensing specialty pharmacy. Products are dispensed by the applicable specialty pharmacy and certain services are only accessed by calling the pharmacy directly. Certain specialty medications may not qualify.

Products that qualify as preventive services may be available at a lower cost share or no cost share, depending upon your plan, and may change from time to time. Please check your plan benefit materials should you have any questions about your coverage. Certain drug options identified above may be subject to additional prior authorizations or other plan design restrictions. Please consult your plan for further information.

This information is not a substitute for medical advice or treatment. CVS Caremark assumes no liability whatsoever for the information provided or for any diagnosis or treatment made as a result of this information.

Members acknowledge that by directing their prescribers, or their agents, to send prescriptions to CVS Caremark they are also providing express consent for CVS Caremark to provide prescription services to those members for those prescriptions. Members acknowledge that by directing their prescribers, or their agents, to send prescriptions to the applicable specialty pharmacy, they may also be providing express consent to utilize any affiliated pharmacies to process their prescriptions. Plan Member Rights and Responsibilities can be found at [Caremark.com](https://www.caremark.com).





Mobile app

Manage your Rx on your own time

We make it easy to keep track of your Rx, check for savings and more from your mobile device.

Our mobile app gives you a secure, simple way to manage your prescription benefits and member information. Find a nearby pharmacy no matter where you are. Learn about your medication and get information you can trust day or night. Do all this – and much more – at your convenience.

Keep an eye on drug costs and check for lower-cost alternatives that may save you money.

Order and track refills – even get timely refill reminders – so you never miss a dose.

Stay on top of order status so you know when to pick up your medication or watch for delivery by mail.

Access your Rx list, member ID cards and Rx history at your doctor’s office or anytime you need them.



Learn more at [Caremark.com/OpenEnrollment](https://www.caremark.com/OpenEnrollment) or scan the code.

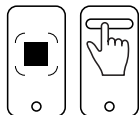

To scan the QR code:
Open the camera on your smart phone
Focus on the QR code
Tap the link that appears